

# DOORS TO SET YOU FREE.

TESTED FOR  
200,000 SWING  
CYCLES.



JSW Centre,  
Bandra Kurla Complex,  
Bandra East,  
Mumbai - 400051, India  
Phone: +91 22 4286 3000

Rest of India  
Dipesh Jain: +91 76668 95379  
(dipesh.jain@jsw.in)  
Rahul Kejriwal: +91 98206 21120  
(rahul.kejriwal@jsw.in)

For South Region  
Vishwas.S: +91 98865 02505  
(vishwas.s@jsw.in)

German Engineered Steel Doors

German Engineered Steel Doors

[www.jswsteeldoors.in](http://www.jswsteeldoors.in)



[www.jswsteeldoors.in](http://www.jswsteeldoors.in)



SIZE: 9" X 11" (OPEN SIZE: 18" X 11")

PAGE- 01

# WELCOME TO THE WORRY-FREE WORLD OF AVANTE.

A German-engineered steel door that is tested for 200,000 swing cycles.

Avante is a unique combination of the strength of steel and the warmth of wood. It stands out by exuding not only style and panache but also durability and longevity. This smart door is designed to overcome all the common threats that are associated with wooden doors like seasonal door jams, fear of fire, termites and heavy-handed installation process. Avante is not just a conventional door; it is a statement of strength and elegance that is here to ring in a new era of worry-free doors for your home.



SWING CYCLE- A single opening and closing sequence of the door.

# ADVANTAGE AVANTE

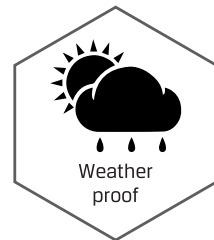

**WEATHER PROOF DOORS**  
Not just a fair-weather friend. Avante doesn't shrink or swell with the changing weather. A be-all and end-all solution to your monsoon worries.



**FIRE RESISTANT DOORS**  
You will need a furnace to bring this down. Avante stands tall in the case of fire and could give up to 2 hours of "evacuation time". A perfect solution for a stress-free exit.

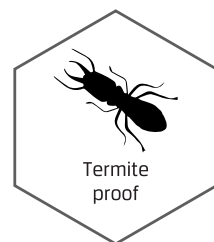

**TERMITE PROOF DOORS**  
No more hollow knocks. Avante fully eliminates the possibility of a termite attack. A guaranteed fix for a termite free home.



**EASY TO INSTALL**  
No more carpenter woes. Once assembled, it is ready to install ensuring best turnaround time for both; the homeowners and the professional contractors.



**ECO-FRIENDLY**  
No trees were trimmed to construct this door. Avante is an environmental friendly steel door manufactured in a compliant facility.



SIZE: 9" X 11" (OPEN SIZE: 18" X 11")

# INSIDE-OUT

- Doors are designed to be fully flushed without any joints on the surface.
- The door and the frame are provided with adequate internal reinforcement in specific areas where hardware is mounted for additional strength.
- The honeycomb infill has high crushing strength leading to impact resistance. The infill material also ensures there is no metallic noise while the doors are knocked or closed.
- The frame is made with mitered joints. It arrives in knocked down form and is assembled on-site.
- The frame is mounted on the wall opening with suitable anchor fasteners. The frame can also be filled with PUF or cement slurry (as required) to give a solid feel.

## INTERNAL SUPPORT ELEMENTS

Steel reinforcements are provided internally for structural stability and integrity.



## HONEYCOMB FILLING

This hexagonal infill made out of craft paper has unique properties that enhances structural integrity and ensures minimal weight addition.

## STEEL SHEETS

The steel used in the doors is galvanized, coated with primer and painted. This offers triple protection from any atmospheric interaction. They are easy to maintain, tough to the core and provide the greatest longevity.



# PLAIN FINISH DOORS

- These are simple flush doors that are high on aesthetics and low on maintenance.
- Available in a range of RAL shades to suit your décor.

Material: Galvanized steel with PU paint  
 Infill: Honeycomb Core  
 Size: Wall Opening  
 Min: 750 x 2100 mm  
 Max: 1200 x 2400 mm

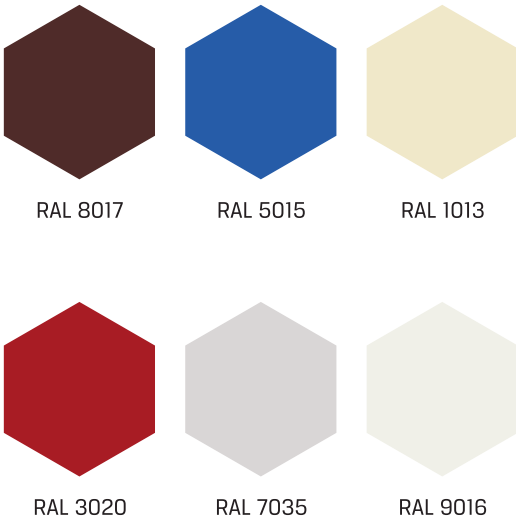

\*Colours may vary on actual product. Above colours are indicative.



SIZE: 9" X 11" (OPEN SIZE: 18" X 11")

# WOOD GRAIN FINISH DOORS

- These doors have natural wood finish with a textured surface.
- The wood grain texture gives these doors a premium look and feel.
- Available in natural wooden colours.

Material: Wood grain finish steel  
 Infill: Honeycomb Core  
 Size: Wall Opening  
 Min: 900 x 2100 mm  
 Max: 1200 x 2400 mm



\*Wood finishes are indicative and will vary against batch quantity.



PAGE- 07

# CLASSIC EMBOSSED WOOD GRAIN FINISH DOORS

- These doors have natural wood finish with a textured surface and with design embossed on it.
- Available in natural wooden colors.

Material: Wood grain finish steel  
 Infill: Honeycomb Core  
 Size: Wall Opening  
 Min: 1000 x 2100 mm  
 Max: 1200 x 2400 mm



Dark Mahogany

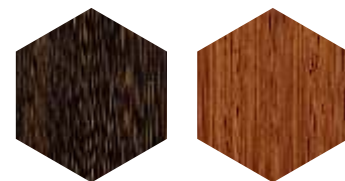

Moorish Teak

Natural Teak

\*Colours may vary on actual product. Above colours are indicative.

SIZE: 9" X 11" (OPEN SIZE: 18" X 11")

# SIX PANEL EMBOSSED WOOD GRAIN FINISH DOORS

- These doors have natural wood finish with a textured surface and with design embossed on it.
- Available in natural wooden colors.

Material: Wood grain finish steel  
 Infill: Honeycomb Core  
 Size: Wall Opening  
 Min: 1000 x 2100 mm  
 Max: 1200 x 2400 mm



Moorish Teak

Natural Teak

Dark Mahogany

## ALSO AVAILABLE IN PLAIN FINISH COLOUR

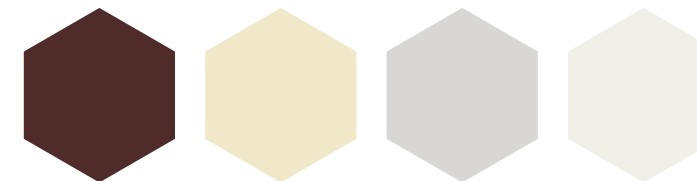

RAL 8017

RAL 1013

RAL 7035

RAL 9016

\*Colours may vary on actual product. Above colours are indicative.

# COMBINATION DOORS

- These doors come with a combination of main door and security grill door fitted in a twin rebate frame.
- They are available in a range of colours, both in plain finish and wooden texture.

Material: Galvanised steel with PU paint  
 Infill: Honeycomb Core  
 Size: Wall Opening  
 Min: 1000 x 2100 mm  
 Max: 1200 x 2400 mm

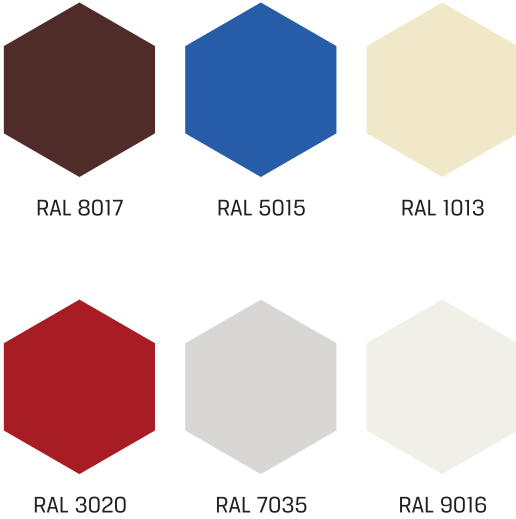

\*Colours may vary on actual product. Above colours are indicative.  
 \*Make to Order

# FRAMED GLASS DOORS

- These doors have an outer steel frame and the glass panel mounted centrally.
- The frames can accommodate glass panels of various design and transparency levels.

Material: Galvanized Steel with PU paint.  
 Infill: Honeycomb Core  
 Size: wall opening  
 Min: 1000 x 2100 mm  
 Max: 1200 x 2400 mm

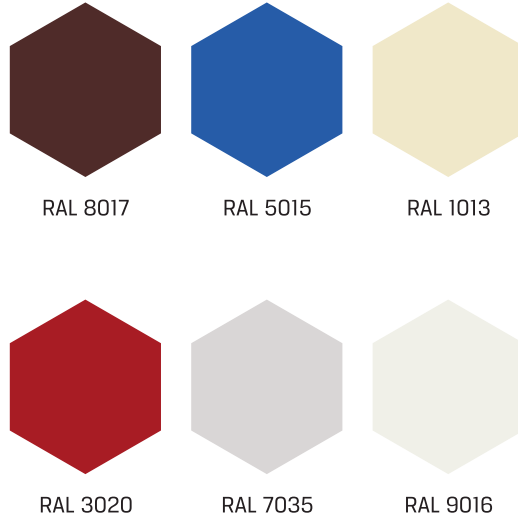

\*Colours may vary on actual product. Above colours are indicative.  
 \*Make to Order

# HARDWARE HORMANN

## HINGE



Stainless steel ball bearing butt Hinge

## EURO PROFILE CYLINDERS



Euro profile cylinder with both side key



Euro profile cylinder with one side key and one side thumbturn

## DOOR CLOSERS



Concealed door closer



Door closer HDC13 (FD)  
Door closer HDC03

## LOCKS



Multipoint Locking LVR x Knob



Mortise sashlock with steel latch & Dead bolt HI-ZK



Mortise sashlock H8 (Fire rated)



WC lock with nylon latch and nylon Dead bolt H3-ZK



Mortise sashlock H9 with Steel latch (Fire rated)



Multipoint lock KFV

## ACCESSORIES



Eye Viewer



Door Guard



Threshold Rebated



Floor Stop



Wall Stop

## LEVER HANDLES AND PULL HANDLES



Lever handle for multipoint lock ERA



HR2-B Polymide Lever handles with roses and escutcheons black



HR2-W Polymide Lever handles with roses and escutcheons white



Stainless steel lever handle - ES1B



HR3-B Polymide Lever handles roses and indicator black



HR3-W Polymide Lever handles roses and indicator white



LT001 Stainless steel lever handle U type



LT002 Stainless steel lever handle L type



D type pull handle L: 300mm



H type pull handle CTC: 300mm

# TECHNICAL

## FRAME PROFILE

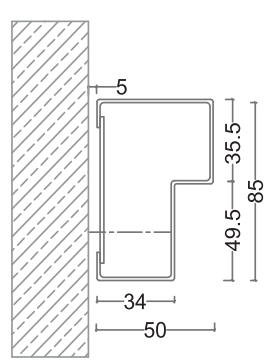

Standard: 85x50mm

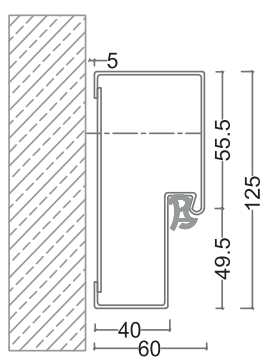

Standard: 125x60mm

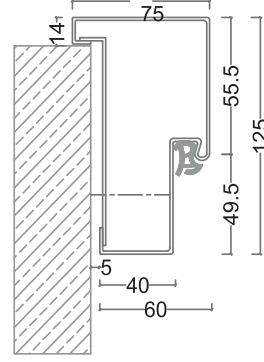

Architrave: 125x60x75mm

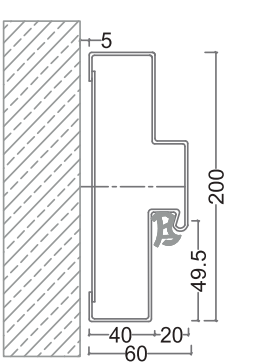

Standard: 200x60mm

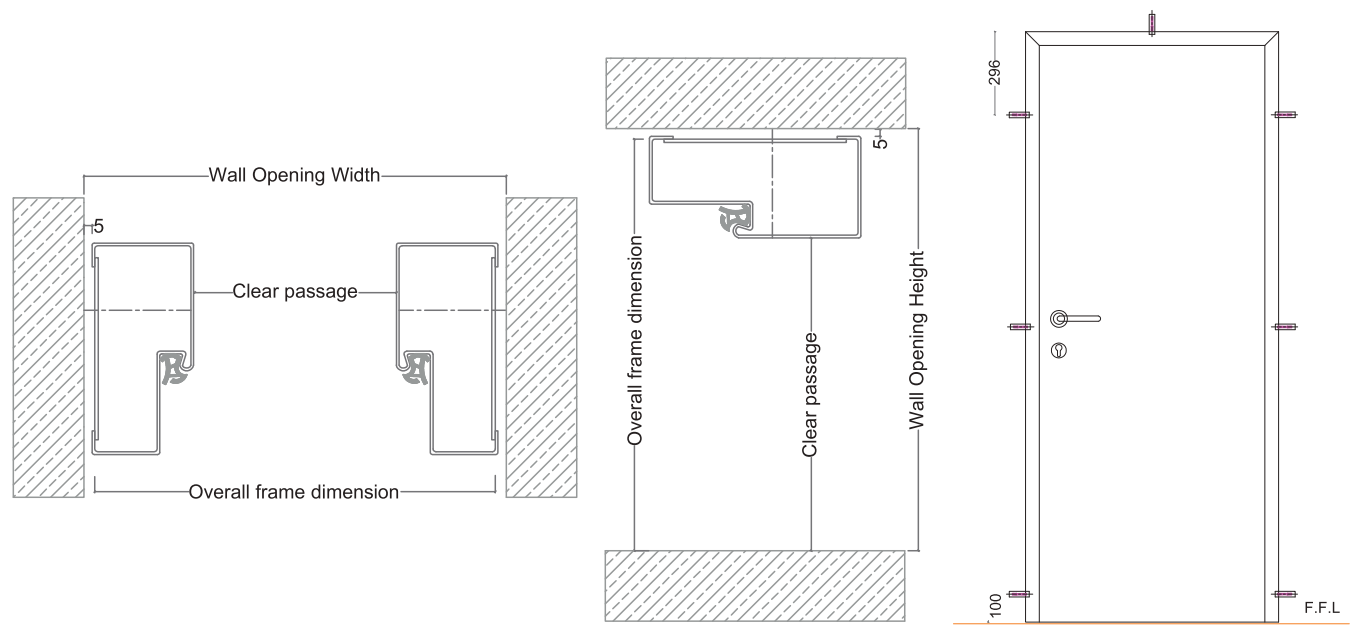

Anchor Spacings

## PROFILE THRESHOLD

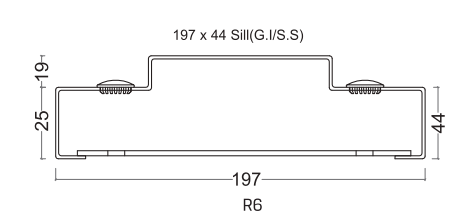
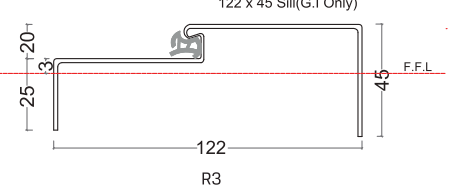
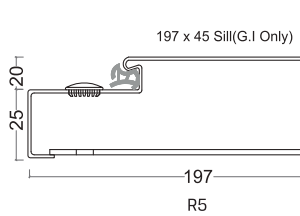
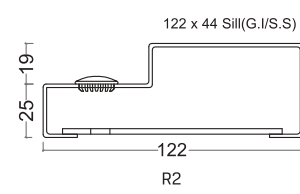
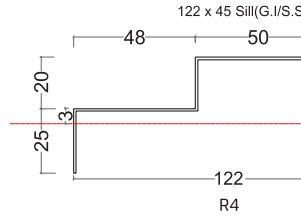
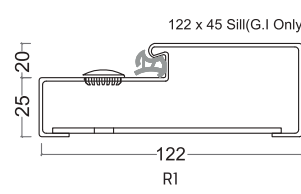

# JSW STEEL

JSW Steel is the flagship company of the JSW Group and is one of India's largest integrated steel manufacturers. With a capacity of 18.3 MTPA, never a day goes by without making significant contributions to a nation that's making progress through leaps and bounds. With state-of-the-art manufacturing facilities located in Karnataka, Tamil Nadu, and Maharashtra, it places innovation and quality at its cornerstone. A manufacturing philosophy that is reflected in everyone among a gamut of steel products Like Hot Rolled, Cold Rolled, Bare & Pre-painted Galvanized & Galvalume", TMT Rebars, Wire Rods and Special Steel.

And to ensure we stay at the top of the game of technological advancements JSW has forged a technological collaboration with JFE Steel Corp, Japan for manufacturing high-strength and advanced high-strength steel for the automobile sector. And the same commitment is reflected in our partnership with Marubeni-Itochu Steel Inc. Tokyo, to set up state-of-the-art steel processing centers.

JSW Coated products Ltd is India's largest manufacturer and exporter of coated steel as well as colour coated steel. Located strategically, near major ports, the production facilities at the Tarapur and Vasind Works or even the Kamleshwar works, located near Nagpur, ensures demands are meant without ado across all regions.



#### Disclaimer

"While every effort has been made to ensure the accuracy of the information contained in this publication, the use of the information is at the reader's risk and no warranty is implied or expressed by JSW Steel with respect to the use of information contained herein. The information in this publication is subject to change or modification without notice. Please contact the JSW Steel office for the latest information.